

2023 - 2024

# JEDBURGH GRAMMAR CAMPUS GUIDE FOR PUPILS & PARENTS / CARERS



Jedburgh  
Grammar  
*Campus*

WELCOME TO

JEDBURGH GRAMMAR CAMPUS

---

# CONTENTS

SCHOOL VALUES .....	3
TERM DATES 2023/2024 .....	4
ABOUT JEDBURGH GRAMMAR CAMPUS .....	5
HOME SCHOOL PARTNERSHIP .....	6
THE SCHOOL DAY .....	8
THE CAMPUS LAYOUT .....	11
WHAT DO YOU WEAR AT SCHOOL .....	14
WHAT DO YOU NEED TO BRING .....	15
OUTSIDE SCHOOL HOURS .....	17
QUESTIONS .....	18

---

---

# SCHOOL VALUES

## Vision

The objective set out for an intergenerational campus in Jedburgh was to deliver a community asset which would deliver benefits to the health, wellbeing and learning opportunities across Jedburgh and the surrounding rural communities, summed up in our vision statement.

Learning without Limits

## Aims

To realise our vision we aim to:

- Ensure an environment where everyone who enters feels welcome and is treated with kindness and respect
- Provide high quality learning and teaching at all levels
- Improve outcomes for children and young people in terms of well-being, attainment, achievement and sustained positive destinations
- Deliver an innovative curriculum that provides employability pathways to meet the needs of the local economy
- Develop effective partnerships to strengthen opportunities for local community

## Values

The core values, which will guide us, were agreed through consultation with pupils, parents, staff and members of the community:

Kindness

Achievement

Learning

Respect

Wellbeing

## TERM DATES 2022/2023

<b>Date</b>	<b>Year Group/Event</b>	<b>Venue</b>
Tue 21 <sup>st</sup> May	P5 Countryside Day trip	Springwood Park
Wed 22 <sup>nd</sup> May 6.00pm	New P1 Parents' Meeting	Assembly Hall
Wed 22 <sup>nd</sup> – Fri 24 <sup>th</sup> May	S2 Residential	Whithaugh Park
Thu 30 <sup>th</sup> May 7.00pm	Senior Leavers' Ceremony & Prom <i>S4-6 parents/carers welcome</i>	Assembly Hall
Wed 5 <sup>th</sup> June	P6 Inspire trip	Springwood Park
Thu 6 <sup>th</sup> June	S2 Inspire trip	Springwood Park
Tue 11 <sup>th</sup> June 7.00pm	Concert (JGC musicians)	Assembly Hall
Wed 12 <sup>th</sup> June	P4 – S6 Sports Day	Spider Park
Fri 14 <sup>th</sup> June	P1-3 Sports Day	JGC 3G pitch
Wed 19 <sup>th</sup> – Fri 21 <sup>st</sup> June	P7 Residential	Ford Castle
Thu 20 <sup>th</sup> June	S1 Highland Show trip	Ingliston, Edinburgh
Mon 24 <sup>th</sup> June 1.45pm	Primary End of Year Celebration <i>P7 parents/carers welcome</i>	Assembly Hall
Tue 25 <sup>th</sup> June 2.45-3.15pm	P1 and P2 Mini Jed Callant's Festival <i>P1&amp;2 parents/carers welcome</i>	Primary playground/ Atrium
Thu 27 <sup>th</sup> June	Secondary Award Ceremony <i>Parents/carers by invitation</i>	Assembly Hall
Fri 28 <sup>th</sup> June	Last day of term	

# ABOUT JEDBURGH GRAMMAR CAMPUS

---

<i>ADDRESS:</i>	Priors Road Jedburgh TD8 6HH
<i>TELEPHONE NO:</i>	01835 863273
<i>EMAIL ADDRESS:</i>	JGC@scotborders.gov.uk
<i>WEBSITE:</i>	<a href="http://www.jedburghgrammarmacampus.com">www.jedburghgrammarmacampus.com</a>

We are an all through 2-18 school with Nursery, Primary & Secondary facilities and a combined roll of 874 pupils. The Campus which will open in August 2020 is the newest school in Scotland and will provide innovative new ways of delivering high standards of learning and teaching. We have a combined teaching staff of 77 across the school and are supported by 52 non-teaching staff.

Although a brand new school, we can trace our history back to the 15<sup>th</sup> Century when a school was first established and attached to the Abbey. In addition to pupils of the town and surrounding areas, the campus will also cater for pupils from the associated primary schools of Denholm and Ancrum.

Your Pastoral Teacher is your personal link with other areas of the school. Your Pastoral Teacher will be allocated to you in first year and that person is your link for all the time you are at secondary. Although all staff are keen to help you make the most of your time here, your Pastoral Teacher is the teacher who will take a special interest in you. Your Pastoral Teacher is your first line of help if you have any questions or problems.

## **HOME SCHOOL PARTNERSHIP**

### **A NOTE TO PARENTS/CARERS**

Parents/carers know their child best. That's why it is important that staff and parents/carers are able to keep in touch.

There may be things you want us to know about your child such as important medical or personal issues. It may also be helpful information such as they need to sit close to the board to see or that they will do anything for a sticker! There may also be times staff need to get in touch with parents/carers. It could be to share your child's success or ask for your support to help their learning.

Please ensure the school has up to date information so you can be contacted.

If you would like to speak to a member of staff, then please phone the school or pop into the reception to make an appointment with your child's Pastoral Teacher.

You can also keep up to date with information on the school Facebook pages. We have separate pages for each school stage to ensure you can access the information most relevant to you. These are updated regularly with curricular (and extra-curricular) information, the weekly bulletin, opportunities, job vacancies and pupil (and former pupil) achievements. There is also the Jedburgh Grammar Sport Facebook page which shares relevant sporting information, like fixtures and results. We also share news and examples of pupil learning and achievement via Instagram and Twitter.

Please get in touch if you would like to know more about the curriculum, a particular subject or if you would like to find out how to help support your child's learning.

## **HOW TO HELP**

One of the easiest ways to help support your child is to ask them about their learning.

Here are some other questions you might like to try to draw some more blood (information) out of a stone (child).

1. Tell me something you learned today that you didn't know yesterday
2. What was the hardest thing you did at school today?
3. What are you looking forward to doing at school tomorrow?
4. Can you show me something you learned today?
5. What did you help someone with in class today?

## **AND FINALLY**

Despite the common perception that parents/carers have less influence over their children as they enter adolescence, research in to the power of parental involvement (Patrikakou 2008) suggests that 'high school students believe they can do better at school if they know their families are interested in their school work and expect them to succeed.'



# THE SCHOOL DAY

---

School begins at 8.50am each day

From Monday to Thursday school ends at 3.45 and on Friday at 1.20pm.

Monday to Thursday			Friday		
Period 1	8.50	9.40	Period 1	8.50	9.40
Period 2	9.40	10.30	Period 2	9.40	10.30
Break	10.30	10.45	Break	10.30	10.50
Period 3	10.45	11.35	Period 3	10.50	11.40
Period 4	11.35	12.25	Period 4	11.40	12.30
Period 5	12.25	13.15	Period 5	12.30	13.20
Lunch	13.15	14.05			
Period 6	14.05	14.55			
Period 7	14.55	15.45			

## LUNCHTIMES & INTERVALS

At lunchtimes and at interval you may use the secondary part of the playground. You will be told in which area of the school you may shelter in wet weather. You must stay on school grounds at break time but can go home or down the street at lunchtime.

## SCHOOL CANTEEN

The school canteen sells a wide range of self-service hot/cold snacks and meals. The canteen menus can be seen on the school website. Our school canteen is a 'cashless canteen' and parents/carers can top up using ParentPay. You can also bring a packed lunch. All food must be eaten in the dining area.

For information on free school meals and financial assistance towards clothing go to [www.scotborders.gov.uk/fsm](http://www.scotborders.gov.uk/fsm)

If you require assistance in completing an application please contact the school.

## **EXTRA INFORMATION FOR PUPILS**

There are digital screens throughout the Campus, information about meetings or extra-curricular activities is displayed on these every day. You should watch them carefully in order to know what is available to you or where you need to go. Information is also available in the weekly bulletin which is also displayed on the digital screens

## **DROP IN CENTRE**

A drop in Centre runs during one lunchtime a week. Pupils may go along and talk to an NHS nurse.

## **CAREERS**

An adviser visits the school each week to offer help with careers choices. Our SDS adviser, Kim Ferguson is available to meet with parents/carers and pupils. More details about this service are included in the S1 induction pack.

## **CLASSES**

You have 7 periods each day Monday to Thursday and 5 periods on Fridays. The majority will be single periods of 50 minutes – but some may be double periods where subjects need more time.

All S1 pupils study the same subjects. Some will be new to you.

English	Home Economics	RME
Maths	ICT	Science
Art	Music	Social Subjects
French	PE	German
Health & Wellbeing	Personal & Social Ed	Technical

You may wish to receive instrumental instruction for strings/brass/woodwind/etc. this may be available and you should see Mrs Lawson, the Music Teacher.

## Technology

All pupils have their own iPad which is to be used in school and at home to support learning. Pupils must ensure that their iPad is suitably charged and available for use in all classes. Teachers will plan learning around the use of digital technology, therefore pupils must always have their iPad available to engage in lessons. Pupils are responsible for their iPad at all times and must ensure that it is safely transported to and from school and around the building.

All pupils will study ICT in S1 and will be given a password to allow access to the school computers. The main computer suites are in Computing and laptops which are used in many departments.

Given the investment in iPads there is no need for pupils to bring their own electronic devices to access online resources. **Pupils should not use mobile telephones in school.** If parents need to relay an urgent message to their child (or vice versa) this can be done via the school office.

## Ground Floor – Mostly Primary and Nursery

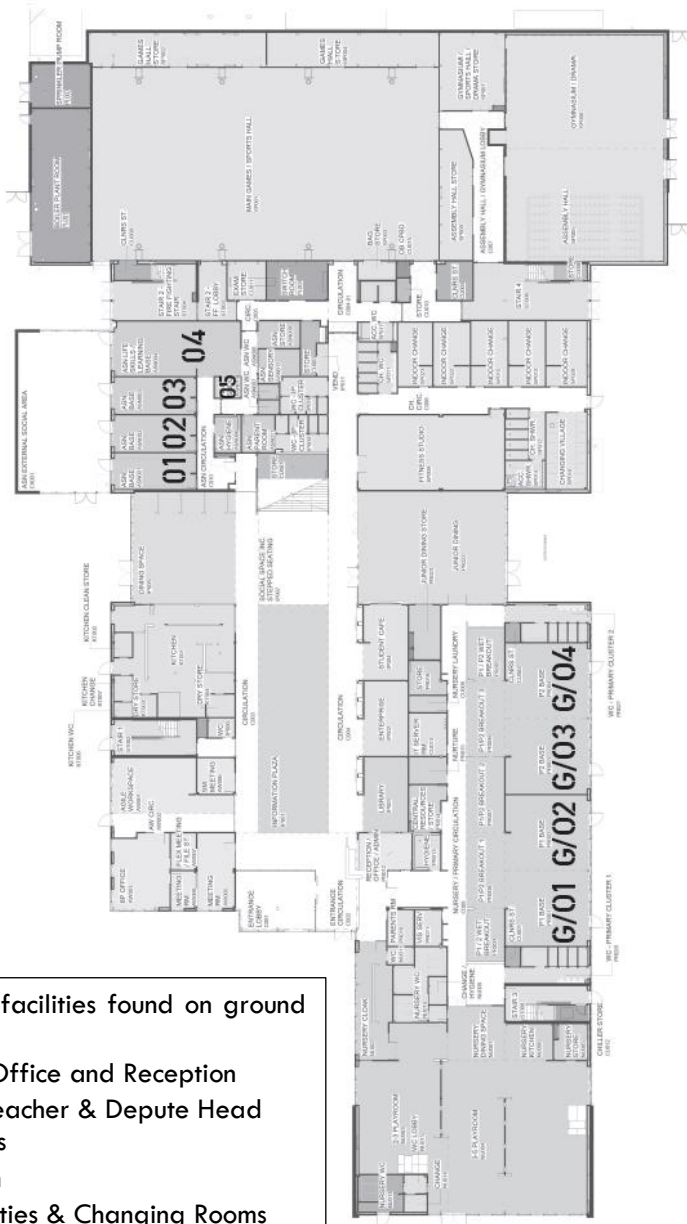

### Secondary facilities found on ground floor:

- School Office and Reception
- Head Teacher & Depute Head Teachers
- Canteen
- PE Facilities & Changing Rooms
- Rose Hub

## 1st Floor – Mostly Secondary

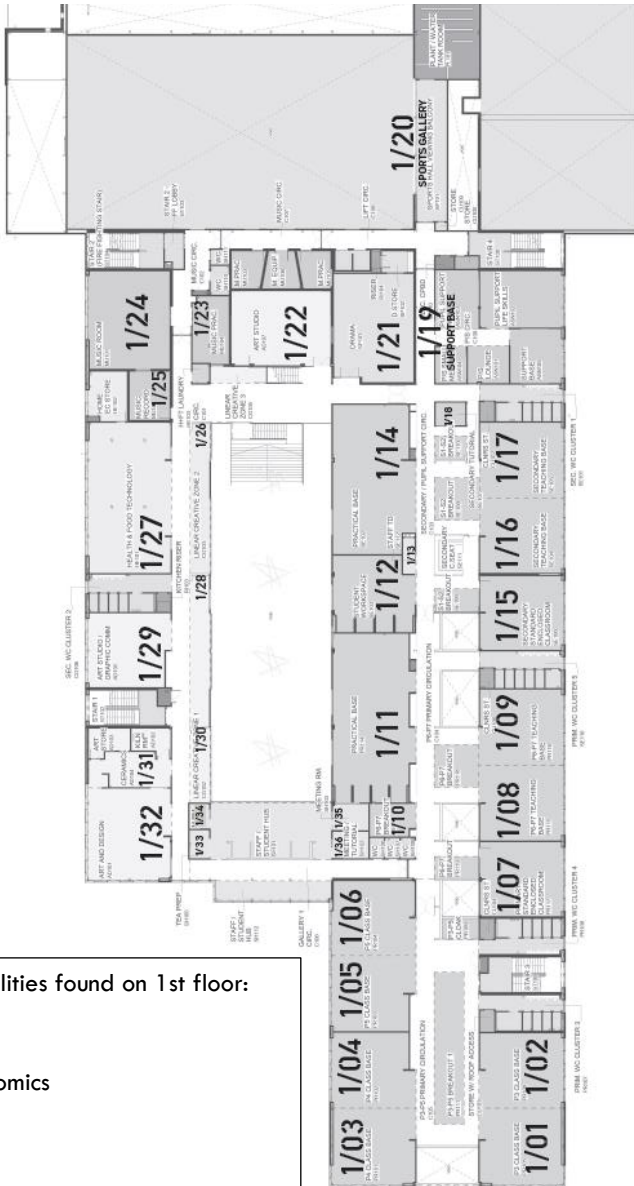

### Secondary facilities found on 1st floor:

- Art
- Computing
- Home Economics
- Music
- English
- Drama
- Modern Languages
- Support for Pupils/Pastoral Staff

## 2nd Floor – Secondary



Secondary facilities found on 2nd floor:

- Social Subjects
- Business Studies
- Sciences
- Technical Subjects
- Mathematics

# WHAT YOU WEAR AT SCHOOL

---

## SCHOOL UNIFORM

The JGC Dress Code is designed to encourage pupils to identify with the school.

- Black Trousers/Skirt/School Shorts
- White Shirt /Blouse
- Dark Footwear, preferably school shoes
- School Tie \*\*
- Plain Black Jumper/Cardigan \*

*\*School jumpers with the school badge are available from Middlemiss Embroidery.*

*\*\*Ties are available to purchase on ParentPay.*

## WHAT YOU SHOULD NOT WEAR

The school is a place to work – you should keep casual clothes for evenings and weekends. In particular, jeans and other denim clothing will not be allowed. Trainers in any colour other than black should only be worn in PE and not as part of your school uniform.

## PREFERRED PE/SPORTS KIT

Pupils will experience a variety of activities (aesthetic, team, water-based, fitness, athletics and racket) during S1-3 in order to develop their Physical Fitness, Physical Competencies, Personal Qualities and Cognitive Skills.

### Indoor lessons

T-shirt. This must cover the shoulders, i.e. no vest or crop tops, and have no alcohol/tobacco advertising

Shorts, leggings or tracksuit trousers

Clean trainers

### Outdoor lessons

T-shirt. This must cover the shoulders, i.e. no vest or crop tops, and have no alcohol/tobacco advertising

Shorts, leggings or tracksuit trousers  
Jumper or jacket (weather dependent)

Hockey pitch footwear - Clean trainers or 'astro' trainers with small dimples  
Rugby/football pitch footwear - Studded boots only  
Athletics track footwear - Clean trainers or spikes

### Swimming

Swimming costume/shorts

Towel

Goggles

## **WHAT YOU NEED TO BRING**

---

Obviously, you must always bring your iPad and ensure it is fully charged. A number of charging points are available around the Campus for use at break and lunchtimes. Also you will require a pen, pencil, ruler and a rubber. We are keen to promote reading and this will be reinforced through English classes so all pupils should carry a reading book which will be used at various times.

For some subjects you might need other equipment. For example, for Home Economics a large container is useful for carrying foods to and from school. Also, because the Home Economics Department provide foodstuffs, there may be a cost involved. You will be given instructions about this during class. The Home Economics department will provide each pupil with a plastic apron.

Your teachers will tell you what things you need, so listen carefully when they first give instructions.

## **YOU MAY ALSO BE GIVEN OTHER ITEMS**

You will be given jotters and books and sometimes other equipment which you will need to take home. Remember, these are on loan to you, therefore you must take very good care of them.



You should also have a strong waterproof bag in which to carry everything.

Your valuables should not be left unattended and should be given to your teacher if your bag is stored outside your classroom. It would also be a good idea to make sure your name is clearly marked on games kit, books and other equipment.

# OUTSIDE SCHOOL HOURS

---

You already know about the school day, but things do not need to stop at 3.45 or 1.20pm.

There are many clubs, teams and societies which take place at lunchtime or after school. You can get information about these on the digital screens/weekly bulletin or from various teachers.

## HOMework

Homework is done outside school hours. Homework is set regularly and it is important that you complete it to a high standard. It is also important to hand it in on time. Homework is set through 'Show my Homework' which pupils and parents/carers have access to. Pupils need to check Show my Homework daily on their iPad and ensure they keep up to date with returns to their teachers. Homework tasks will be a mix of digital and paper based activities. Parents/Carers will be issued with a unique PIN code to access their child's Show my Homework account via an App.

You may find it easier to do homework at lunchtime. The campus offers many study areas where you can work.

## PART TIME WORK

If you are 13 or over, you are allowed to have a part-time job. You will need a Work Permit. This sets out when you can work. All the information and an application form are available from your Pastoral Teacher.

# THIS SECTION SHOULD ANSWER SOME OF YOUR QUESTIONS - please read carefully

---

## REMEMBER

You must never go out of school without permission from the school

## WHAT DO YOU DO IF:

### YOU ARE LATE?

Report to the Campus Reception as soon as you arrive and provide an explanation of why you are late. If you are late for school because you have had to visit the Health Centre, you should obtain from their receptionist a copy of the printed form confirming the visit. This should be handed in when you report back to the Campus Reception.

### YOU ARE ABSENT?

Your parents/carers must contact the school by telephone or via Groupcall Xpressions each day stating why you are absent. If this is not done the school will automatically contact parents/carers by Groupcall.

### YOU REQUEST TIME OFF?

You should bring a note from your parents/carers to your Pastoral Teacher, giving the reason for such a request.

### YOU BECOME SICK OR INJURED?

- ***During Classes*** – all injury or sickness must be reported to the Class Teacher who will take appropriate action.
- ***At school before 8.50am, during interval or lunch-break*** – all injured or sick pupils should report to the Campus Reception.

**THE MOST IMPORTANT THING IS –  
IF YOU ARE UNWELL OR INJURED TELL SOMEONE**

## **YOU HAVE A DENTAL OR HEALTH CENTRE APPOINTMENT?**

Show your appointment card to the teacher you have at the beginning of the period affected. If you do not have such a card or written evidence from a parent, we cannot allow you to leave school.

## **YOU HAVE TO GO OUT OF SCHOOL FOR ANY REASON?**

(Including medical appointments) – Before leaving, go to the Campus Reception and sign out. When you return you go straight to the Campus Reception and sign in.

## **IF YOU ARE GIVEN ANY FORMS TO BE COMPLETED?**

Please return any forms completed by your parents/carers promptly.

## **YOU LOSE ANY ITEM OR MONEY ETC?**

At no time should money or articles of value be left in clothing in cloakrooms or in changing rooms. If something does go missing, report it at once to teachers or the Campus Reception, as appropriate. Efforts will be made to retrieve it, but the school is not responsible for the safety of personal property.

## **YOU FIND SOMETHING WHICH DOES NOT BELONG TO YOU?**

Hand it to your teacher, to the Campus Reception or to a Janitor.

## **YOU OR YOUR PARENTS/CARERS ARE WORRIED ABOUT SOMETHING?**

Report to your Pastoral Teacher or make an appointment with them. They will be happy to discuss it with you.

## **YOUR ADDRESS OR TELEPHONE NUMBERS CHANGE?**

Ask your parents/carers to inform the school office in writing of changes to your contact details.

## **YOU ARE ABOUT TO LEAVE THIS SCHOOL?**

See your Pastoral Teacher. They will tell you what needs to be done.